

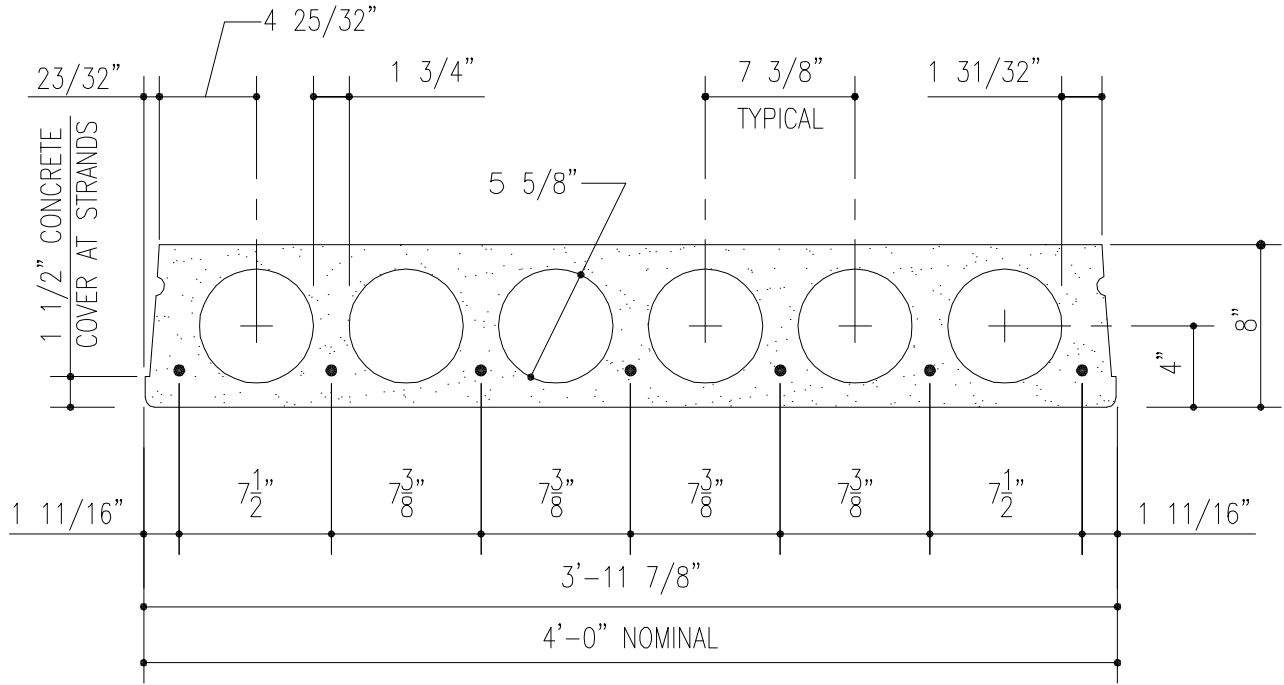

8" CELLA-CORE TECHNICAL DATA SHEET



LOAD TABLE OF ALLOWABLE SUPERIMPOSED LOADS IN LBS. PER SQ.FT.

STANDARD WEIGHT 8" CELLA-CORE PLANK

STRAND	STRAND AREA sq. in.	MU K-ft	CLEAR SPAN IN FEET																						
			14	15	16	17	18	19	20	21	22	23	24	25	26	27	28	29	30	31	32	33	34	35	
4-1/2" ϕ	0.612	70	368	314	270	234	203	177	155	136	120	105	93	82	72	63	55	48	42	36					
5-1/2" ϕ	0.765	86	446	399	344	299	262	230	203	179	159	141	126	112	100	89	79	71	63	56	49	43	38		
6-1/2" ϕ	0.918	101	457	425	395	362	318	280	248	220	196	175	157	141	127	114	102	92	83	74	67	60	54	48	
7-1/2" ϕ	1.071	116	463	435	410	374	328	330	293	261	234	210	189	170	153	139	125	114	103	93	85	77	69	63	

Values below lower heavy line indicate web shear controls.

Values above upper heavy line indicate long-time camber less than zero with no superimposed loads.

MATERIAL PROPERTIES

Net Area.....	225.78 in ²	Strength of Concrete (f 'c).....	6000 psi
Moment of Inertia.....	1767.90 in ⁴	Strength at Release (f 'ci).....	3500 psi
Centroid from Slab Bottom.....	4.00 in	Unit weight of Concrete.....	150 pcf
Section Modulus, Top.....	442.22 in ³	Ultimate Steel Strength.....	270 ksi
Section Modulus, Bottom.....	442.22 in ³	Strand Jacking Stress.....	202.5 ksi
Web Width.....	12.94 in	Strand Type.....	Low Relaxation
V/S Ratio.....	2.13 in	Grout Joint Requirements.....	1707 ft ² /yd ³
Self Weight *.....	62.2 psf	* Self weights based on grouted section	

These tables are for general descriptive purposes only. Actual Cella-Core designs are dependant on local codes and standards, material properties and product end usage.