

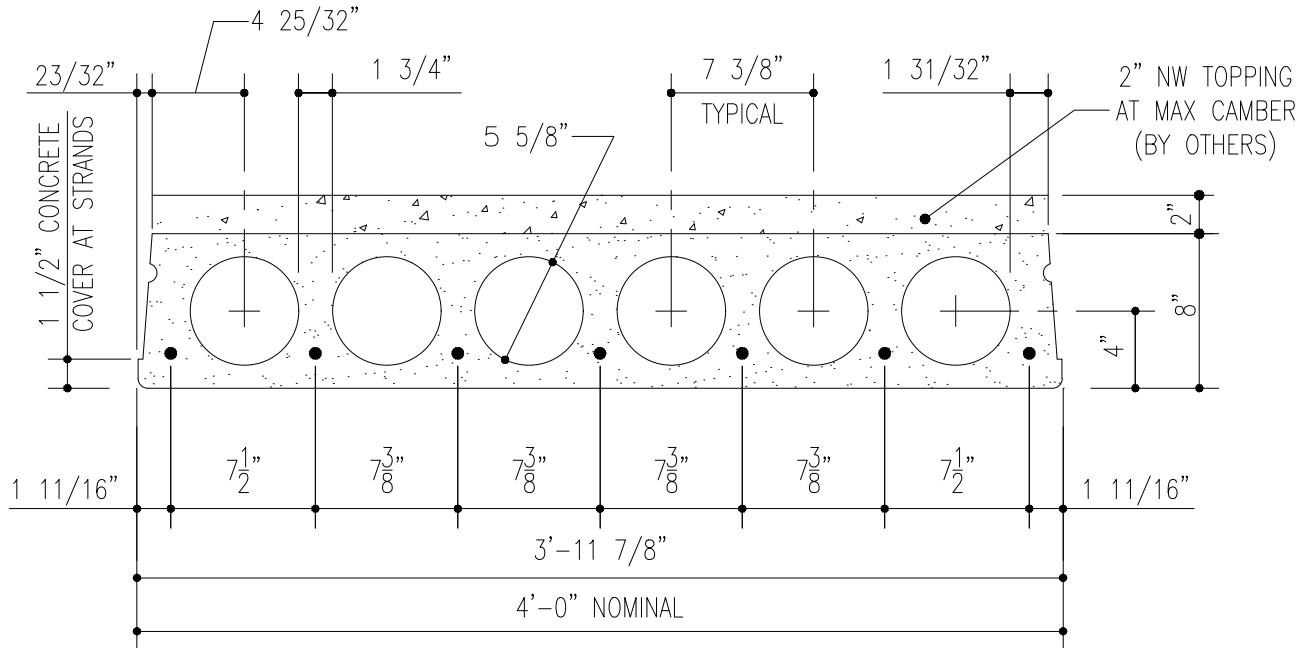

8" CELLA-CORE TECHNICAL DATA SHEET



LOAD TABLE OF ALLOWABLE SUPERIMPOSED LOADS IN LBS. PER SQ.FT.

STANDARD WEIGHT 8" CELLA-CORE PLANK + 2" NW CONCRETE COMPOSITE TOPPING

STRAND	STRAND AREA sq. in.	MU K-ft	CLEAR SPAN IN FEET																											
			14	15	16	17	18	19	20	21	22	23	24	25	26	27	28	29	30	31	32	33	34	35						
4-1/2" ϕ	0.612	95	413	381	353	328	301	263	231	203	179	159	140	124	110	97	86	75	66	58										
5-1/2" ϕ	0.765	116	413	381	353	328	306	287	269	253	234	208	186	166	149	133	119	107	95	85	76	67								
6-1/2" ϕ	0.918	137	413	381	353	328	306	287	269	253	239	226	213	202	187	169	153	138	124	112	101	91	82	74						
7-1/2" ϕ	1.071	157	413	381	353	328	306	287	269	253	239	226	213	202	192	182	173	165	152	138	126	114	104	94						

Values below lower heavy line indicate web shear controls.

Values above upper heavy line indicate long-time camber less than zero with no superimposed loads.

MATERIAL PROPERTIES - COMPOSITE MEMBER

Net Area.....	291.45 in ²	Strength of Concrete (f 'c).....	6000 psi
Moment of Inertia.....	3062.80 in ⁴	Strength at Release (f 'ci).....	3500 psi
Centroid from Slab Bottom.....	5.125 in	Unit weight of Concrete.....	150 pcf
Section Modulus, Top.....	628.26 in ³	Ultimate Steel Strength.....	270 ksi
Section Modulus, Bottom.....	597.63 in ³	Strand Jacking Stress.....	202.5 ksi
Web Width.....	12.94 in	Strand Type.....	Low Relaxation
V/S Ratio.....	2.13 in	Grout Joint Requirements.....	1707 ft ² /yd ³
Self Weight *.....	87.2 psf	* Self weights based on grouted section with 2" topping	

These tables are for general descriptive purposes only. Actual Cella-Core designs are dependant on local codes and standards, material properties and product end usage. Camber of planks must be considered when establishing finished floor elevations. Failure to do so may cause issues in the field with other constructions.