



Boccella Precast, LLC | 324 New Brooklyn Road, Berlin, New Jersey 08009

Phone: (856) 767-3861

Fax: (856) 767-7228

www.boccellaprecast.com

## 8" CELLA-CORE TECHNICAL DATA SHEET

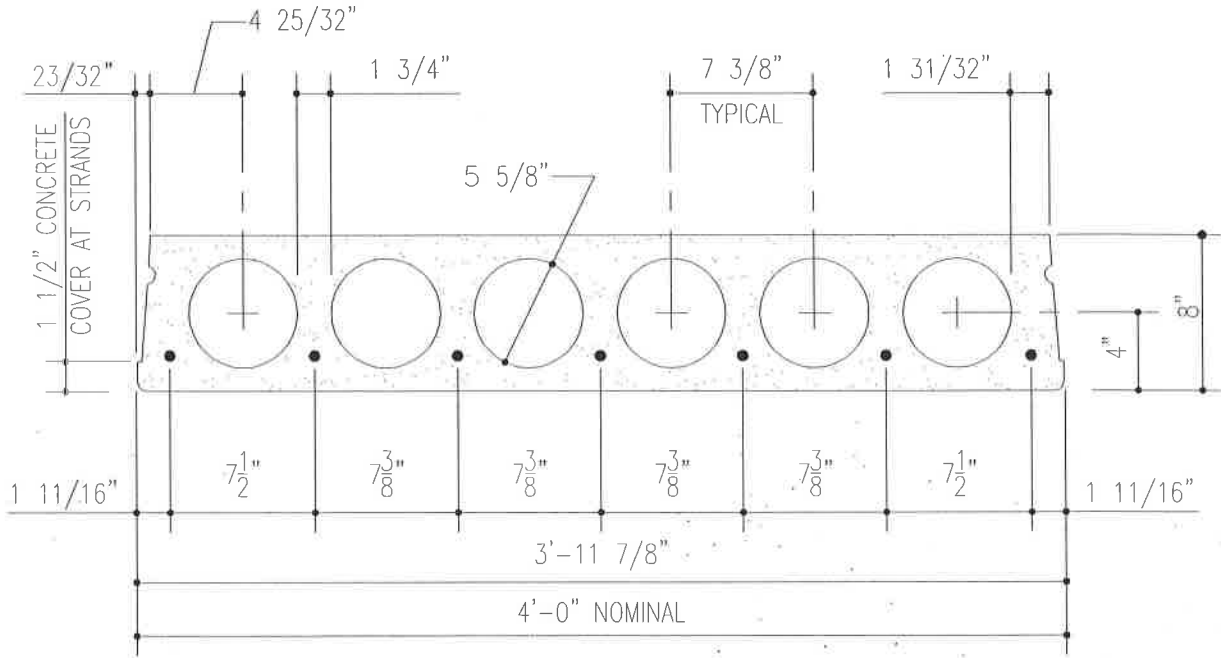

### LOAD TABLE OF ALLOWABLE SUPERIMPOSED LOADS IN LBS. PER SQ.FT.

#### STANDARD WEIGHT 8" CELLA-CORE PLANK

STRAND	STRAND AREA sq. in.	MU K-ft	CLEAR SPAN IN FEET																						
			14	15	16	17	18	19	20	21	22	23	24	25	26	27	28	29	30	31	32	33	34	35	
4-1/2" φ	0.612	70	368	314	270	234	203	177	155	136	120	105	93	82	72	63	55	48	42	36					
5-1/2" φ	0.765	86	446	399	344	299	262	230	203	179	159	141	126	112	100	89	79	71	63	56	49	43	38		
6-1/2" φ	0.918	101	457	425	395	362	318	280	248	220	196	175	157	141	127	114	102	92	83	74	67	60	54	48	
7-1/2" φ	1.071	116	463	435	410	374	328	330	293	261	234	210	189	170	153	139	125	114	103	93	85	77	69	63	

Values below lower heavy line indicate web shear controls.

Values above upper heavy line indicate long-time camber less than zero with no superimposed loads.

### MATERIAL PROPERTIES

Net Area.....	225.78 in <sup>2</sup>	Strength of Concrete ( f 'c ).....	6000 psi
Moment of Inertia.....	1767.90 in <sup>4</sup>	Strength at Release ( f 'ci ).....	3500 psi
Centroid from Slab Bottom.....	4.00 in	Unit weight of Concrete.....	150 pcf
Section Modulus, Top.....	442.22 in <sup>3</sup>	Ultimate Steel Strength.....	270 ksi
Section Modulus, Bottom.....	442.22 in <sup>3</sup>	Strand Jacking Stress.....	202.5 ksi
Web Width.....	12.94 in	Strand Type.....	Low Relaxation
V/S Ratio.....	2.13 in	Grout Joint Requirements.....	1707 ft <sup>3</sup> /yd <sup>3</sup>
Self Weight *.....	62.2 pcf	* Self weights based on grouted section	

These tables are for general descriptive purposes only. Actual Cella-Core designs are dependant on local codes and standards, material properties and product end usage.



Boccella Precast, LLC | 324 New Brooklyn Road, Berlin, New Jersey 08009

Phone: (856) 767-3861

Fax: (856) 767-7228

www.boccellaprecast.com

## 10" CELLA-CORE TECHNICAL DATA SHEET

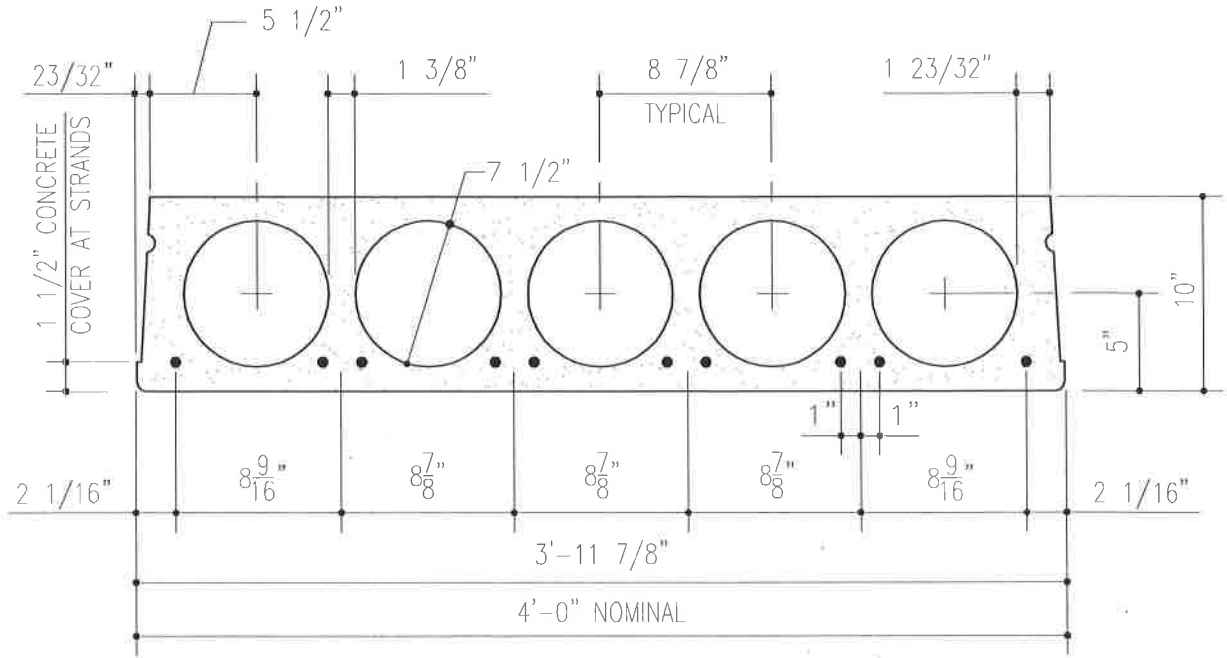

### LOAD TABLE OF ALLOWABLE SUPERIMPOSED LOADS IN LBS. PER SQ.FT.

#### STANDARD WEIGHT 8" CELLA-CORE PLANK

STRAND	STRAND AREA sq. in.	MU K-ft	CLEAR SPAN IN FEET																														
			21	22	23	24	25	26	27	28	29	30	31	32	33	34	35	36	37	38	39	40	41	42	43	44	45	46	47	48	49	50	
4-1/2" $\phi$	0.612	93	194	172	153	136	121	108	96	86	76	68	60	53	46	41																	
6-1/2" $\phi$	0.918	136	239	219	203	182	175	167	165	150	136	124	112	102	93	84	77	69	63	57	51	46	41										
8-1/2" $\phi$	1.224	175	256	238	219	199	182	175	171	165	161	155	146	147	135	124	114	105	96	89	81	75	68	63	57	52	48	43					
10-1/2" $\phi$	1.530	212	265	247	228	210	192	183	175	170	165	160	158	153	147	137	126	118	112	111	108	102	94	87	81	75	69	64	59	54	50	46	

Values below lower heavy line indicate web shear controls.

Values above upper heavy line indicate long-time camber less than zero with no superimposed loads.

### MATERIAL PROPERTIES

Net Area.....	247.99 in <sup>2</sup>	Strength of Concrete ( f 'c ).....	6000 psi
Moment of Inertia.....	3262.40 in <sup>4</sup>	Strength at Release ( f 'ci ).....	3500 psi
Centroid from Slab Bottom.....	5.00 in	Unit weight of Concrete.....	150 pcf
Section Modulus, Top.....	652.46 in <sup>3</sup>	Ultimate Steel Strength.....	270 ksi
Section Modulus, Bottom.....	652.46 in <sup>3</sup>	Strand Jacking Stress.....	202.5 ksi
Web Width.....	9.25 in	Strand Type.....	Low Relaxation
V/S Ratio.....	2.28 in	Grout Joint Requirements.....	1399 ft <sup>2</sup> /yd <sup>3</sup>
Self Weight *.....	68.9 psf	* Self weights based on grouted section	

These tables are for general descriptive purposes only. Actual Cella-Core designs are dependant on local codes and standards, material properties and product end usage.



# 12" CELLA-CORE TECHNICAL DATA SHEET

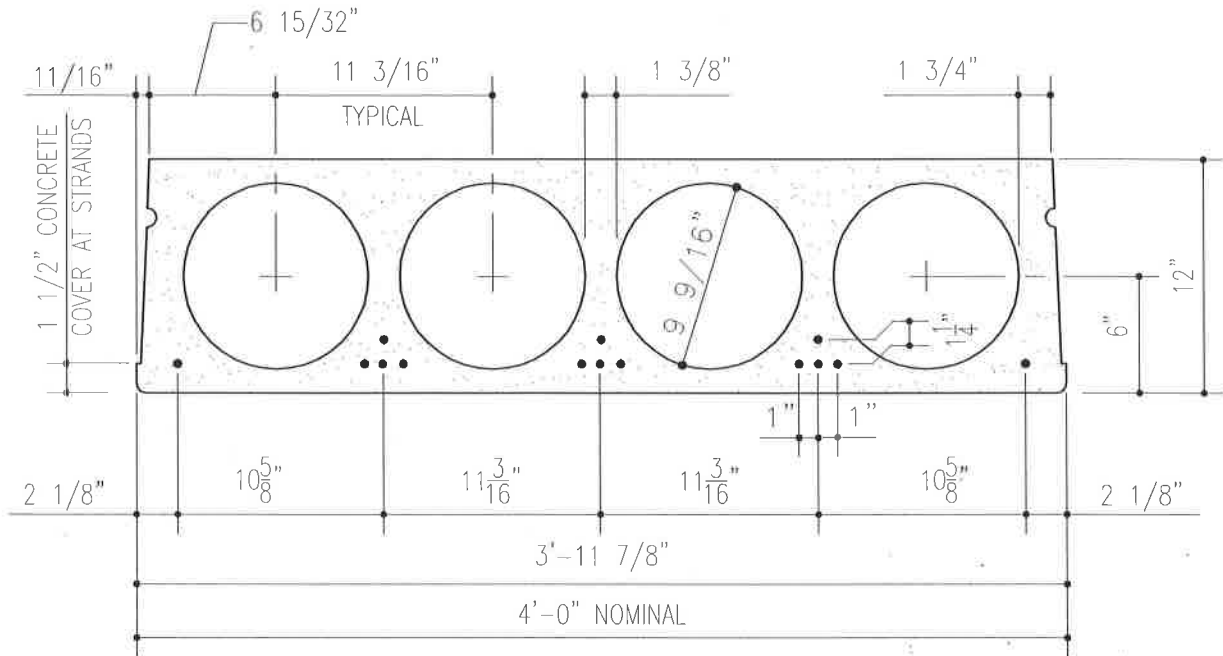

## LOAD TABLE OF ALLOWABLE SUPERIMPOSED LOADS IN LBS. PER SQ.FT.

### STANDARD WEIGHT 8" CELLA-CORE PLANK

STRAND	STRAND AREA sq. in.	MU K-ft	CLEAR SPAN IN FEET																								
			30	31	32	33	34	35	36	37	38	39	40	41	42	43	44	45	46	47	48	49	50	51	52	53	54
4-1/2" $\phi$	0.612	115	90	80	72	64	57	50	44	38	33																
5-1/2" $\phi$	0.765	142	125	114	103	93	84	76	69	62	55	50	44	39													
6-1/2" $\phi$	0.918	169	161	147	134	122	112	102	93	85	77	70	64	58	52	47	42										
7-1/2" $\phi$	1.071	196	165	153	147	144	136	128	118	108	99	91	84	77	70	64	59	54	49	44	40						
8-1/2" $\phi$	1.224	220	172	161	154	150	143	139	132	129	119	110	101	94	86	80	73	67	62	57	52	47	43				
9-1/2" $\phi$	1.377	246	178	169	161	156	149	145	142	136	132	127	121	112	104	96	89	83	76	71	65	60	55	51	47	43	
10-1/2" $\phi$	1.530	266	183	173	163	159	153	147	144	138	135	131	127	126	117	109	101	94	88	81	75	70	65	60	55	51	47
11-1/2" $\phi$	1.683	288																107	100	93	87	81	75	70	65	60	56

Values below lower heavy line indicate web shear controls.

Values above upper heavy line indicate long-time camber less than zero with no superimposed loads.

## MATERIAL PROPERTIES

Net Area.....	275.34 in <sup>2</sup>	Strength of Concrete (f'c).....	6000 psi
Moment of Inertia.....	5352.7 in <sup>4</sup>	Strength at Release (f'ci).....	3500 psi
Centroid from Slab Bottom.....	6.00 in	Unit weight of Concrete.....	150 pcf
Section Modulus, Top.....	892.12 in <sup>3</sup>	Ultimate Steel Strength.....	270 ksi
Section Modulus, Bottom.....	892.12 in <sup>3</sup>	Strand Jacking Stress.....	202.5 ksi
Web Width.....	8.50 in	Strand Type.....	Low Relaxation
V/S Ratio.....	2.47 in	Grout Joint Requirements.....	1161 ft <sup>3</sup> /yd <sup>3</sup>
Self Weight *	77.1 psf	* Self weights based on grouted section	

These tables are for general descriptive purposes only. Actual Cella-Core designs are dependant on local codes and standards, material properties and product end usage.